

# MDTA Series

## Flat Wire Molded Inductor

### Size 1510

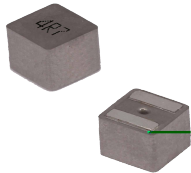

#### FEATURES

- 
- #
- †
- 
- # j
- \ C @
- j

#### APPLICATION

- ) # ) #
- Q ) = @

Dimensions: [mm]

Land Pattern: [mm]

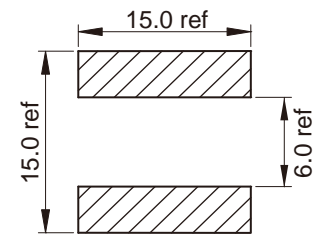
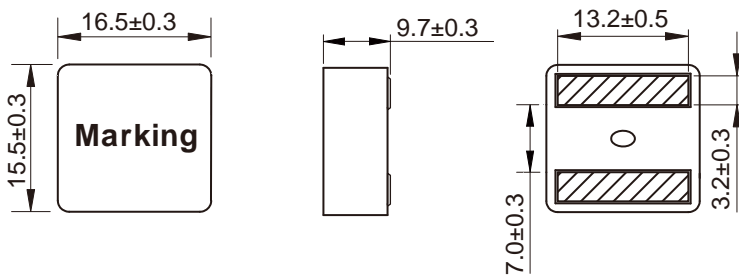

Electrical Properties:

Part No	L@100KHz /0.1V	Tolerance	I <sub>SAT</sub> Typ.	I <sub>R</sub>		R <sub>DC</sub> Max.
				20°C rise	40°C rise	
U) u° k U						
U) u° k U						
U) u° k U						
U) u° k U						
U) u° U						
U) u° U						
U) u° U						
U) u° U						

Saturation Current will cause L to drop approximately 30%  
 Temperature Rise Current that causes the specified temperature rise from 25°C ambient.

## Soldering Reflow:

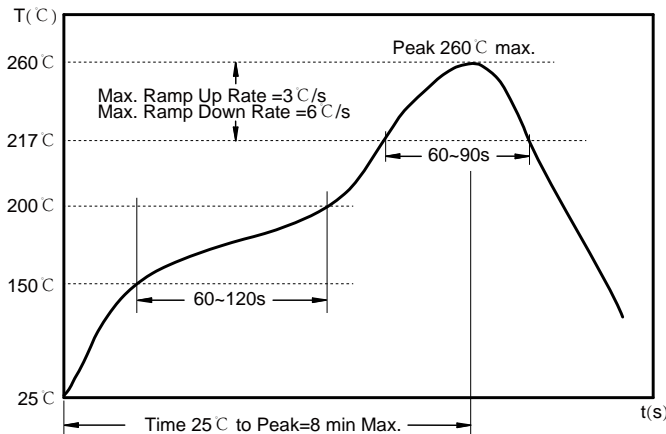

Preheat condition: 150 ~200°C / 60~120 sec.

Allowed time above 217°C : 60~90 sec.

Max temperature: 260°C .

Max time at max temperature: 10 sec.

Allowed Reflow time: 2x max.

## Packaging Information:

### Tape Dimension :

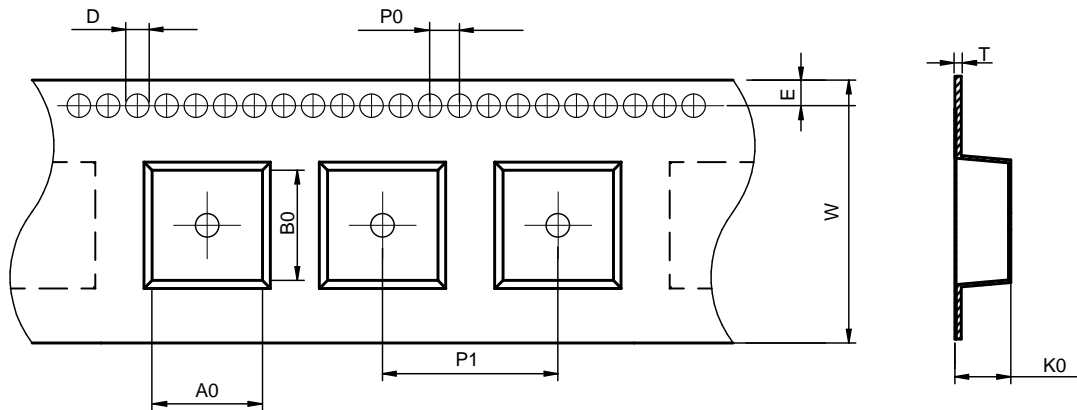

Series	A0 (mm)	B0 (mm)	D (mm)	P0 (mm)	P1 (mm)	W (mm)	K0 (mm)	E (mm)	T (mm)
MDTA1510	17.0±0.1	16.0±0.1	1.5±0.1	4.0±0.1	24.0±0.1	32.0±0.3	10.5±0.1	1.75±0.1	0.50±0.05

### Peel force of top cover tape:

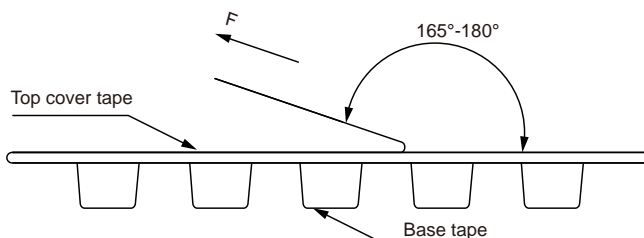

The peel force of top cover tape shall be between 0.1 to 1.3 N

### Product Marking:

Marking	Printing (Inductance)
---------	-----------------------

Reel Dimension: [mm]



Packaging Quantity: