

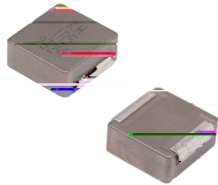

SMD Low Profile High Current Molded Inductor Size 1870



- Shielded construction
 - Capable of corresponding high frequency .
 - Low loss realized with low DCR.
 - High performance (Isat) realized by metal dust core.
 - Ultra low buzz noise, due to composite construction.
 - 100% Lead(Pb)-Free and RoHS compliant.
 - AEC-Q200 qualified
 - Operating temperature: -55 to +155 °C(including self-temperature rise)
 - Quantity: 200PCS
-
- Noise filter for various drive circuitry requiring high temperature operation and peak current handling capability
 - Boost-Converter
 - Buck-Converter DC/DC

Dimensions: [mm]

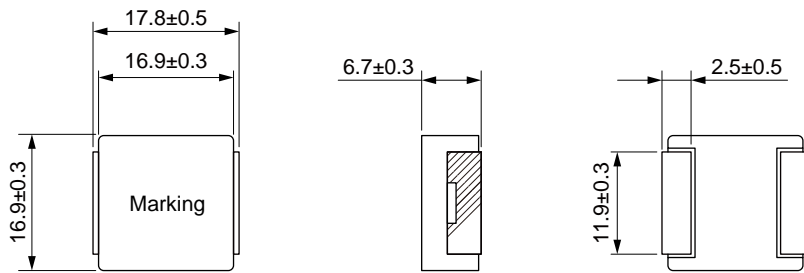

Land Pattern: [mm]

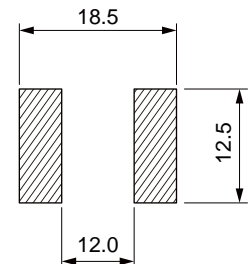

Electrical Properties:

Part Number	DCR [mΩ]	Inductance Tolerance	Isat [A]	Isat @ 30% Drop [A]	Temperature Rise Current [A]	Temperature Rise Current @ 40°C [A]
MDSA1870-1R0M	1.00	±20%	45.0	48.0	1.20	1.40
MDSA1870-1R5M	1.50	±20%	38.0	45.0	1.60	1.90
MDSA1870-2R2M	2.20	±20%	31.0	34.0	2.00	2.50
MDSA1870-3R3M	3.30	±20%	29.0	31.0	3.00	3.80
MDSA1870-4R7M	4.70	±20%	27.0	28.0	4.00	5.00
MDSA1870-6R8M	6.80	±20%	23.0	24.0	6.50	7.80
MDSA1870-100M	10.0	±20%	20.0	21.0	10.0	11.5
MDSA1870-150M	15.0	±20%	15.0	15.0	13.5	16.5
MDSA1870-220M	22.0	±20%	13.0	13.0	21.5	25.0
MDSA1870-330M	33.0	±20%	11.5	11.5	33.0	38.0
MDSA1870-470M	47.0	±20%	9.0	9.0	41.0	48.0
MDSA1870-680M	68.0	±20%	7.8	8.1	68.0	78.0
MDSA1870-820M	82.0	±20%	6.3	7.8	71.0	85.0

Saturation Current will cause L to drop approximately 30%

Temperature Rise Current: The actual value of DC current when the temperature rise is $\Delta T=40^{\circ}\text{C}$



Typical Electrical Characteristics:



Typical Electrical Characteristics:

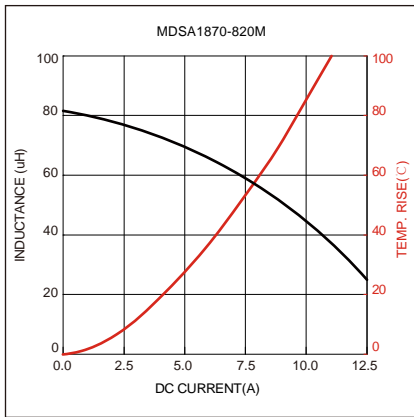

Soldering Reflow:

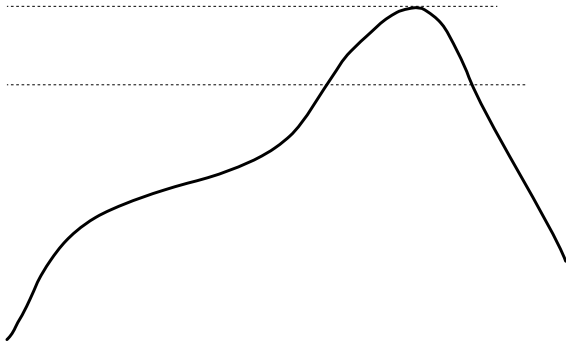

Preheat condition: 150 ~200°C / 60~120 sec.

Allowed time above 217°C: 60~90 sec.

Max temperature: 260°C.

Allowed Reflow time: 2x max.

Packaging Information:

Tape Dimension :

Peel force of top cover tape:

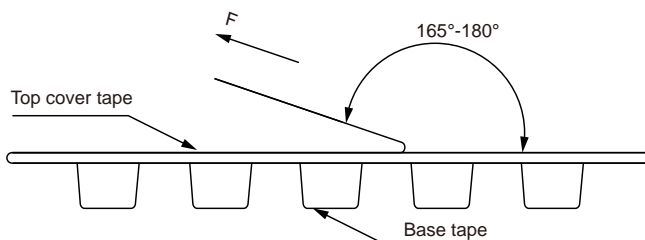

The peel force of top cover tape shall be between 0.1 to 1.3 N

Product Marking:

Marking	KH+Printing (Inductance)
---------	--------------------------



Reel Dimension: [mm]

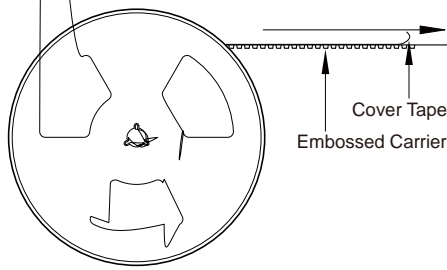

2.2 ± 0.5

330 ± 2.0

97 ± 0.5

32.0 ± 0.5

Packaging Quantity:

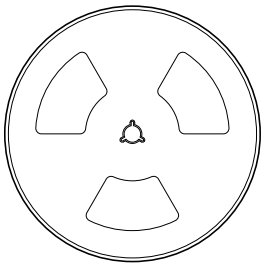

200 Pcs/Reel

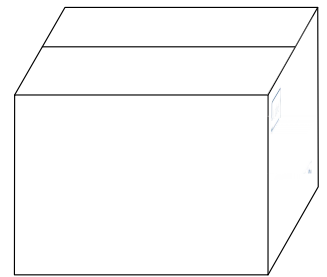

2 Reel /Inner box(400 Pcs)

2 Inner box/Carton box(800 Pcs)

Cautions and Warnings:

- The storage period is within 12 months after the completion of production. Be sure to follow the storage conditions (temperature: -5 to 35°C, humidity: 75% RH Max).If the storage period elapses, the soldering of the terminal electrodes may deteriorate.The warranty period is one year.

-
-
-
-
-
-
-