

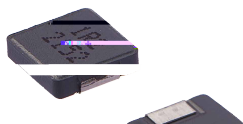

# MD Series

## SMD Low Profile High Current Molded Inductor

### Size 7015



#### CHARACTERISTICS

- Molded type
- High saturation current due to CIP material
- Nature air gap and no acoustic noise
- Different sizes available
- Quantity: 2000pcs

#### APPLICATION

- High current DC/DC converter
- LC filter

Dimensions: [mm]

Land Pattern: [mm]

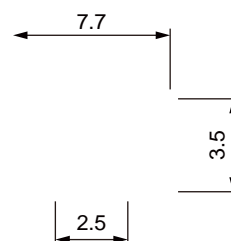
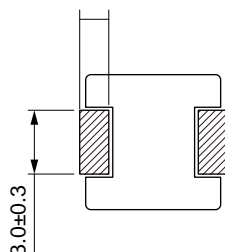
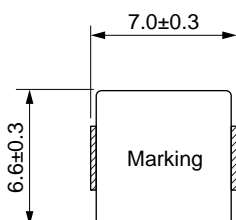

Electrical Properties:

Part No	Inductance @ 100KHz/1V	Tolerance	Temperature Rise Current Typ. (A)	current Typ. (A)	DC Resistance Typ.	DC Resistance Max.
MD7015-R10N	0.10	±30%	17.5	35.0	2.5	3.1
MD7015-R15N	0.15	±30%	16.0	25.0	3.7	4.5
MD7015-R22N	0.22	±30%	14.0	22.0	4.3	5.2
MD7015-R33M	0.33	±20%	11.0	18.0	6.6	7.6
MD7015-R47M	0.47	±20%	9.5	16.0	9.0	10.3
MD7015-R56M	0.56	±20%	9.0	15.5	12.5	14.0
MD7015-R68M	0.68	±20%	7.5	15.0	13.8	15.2
MD7015-R82M	0.82	±20%	7.0	14.0	20.0	24.0
MD7015-1R0M	1.00	±20%	6.5	12.0	23.0	25.8
MD7015-1R5M	1.50	±20%	5.0	9.5	37.0	42.5
MD7015-2R2M	2.20	±20%	4.5	6.5	48.0	55.0
MD7015-3R3M	3.30	±20%	4.2	6.0	62.0	74.0
MD7015-4R7M	4.70	±20%	3.8	5.0	96.0	111
MD7015-5R6M	5.60	±20%	3.0	4.5	115	138
MD7015-6R8M	6.80	±20%	2.6	3.5	128	148
MD7015-8R2M	8.20	±20%	2.4	3.2	153	184



Part No	Inductance @ 100KHz/1V	Tolerance	Temperature Rise Current Typ. (A)	current Typ. (A)	DC Resistance Typ.	DC Resistance Max.
MD7015-100M	10.0	±20%	2.3	2.8	180	216
MD7015-220M	22.0	±20%	1.5	2.5	420	504

Operating temperature: -40°C ~ +125°C

Temperature rise current: The actual value of DC current when the temperature rise is T40°C

Saturation Current will cause L to drop approximately 30%

## Typical Electrical Characteristics:

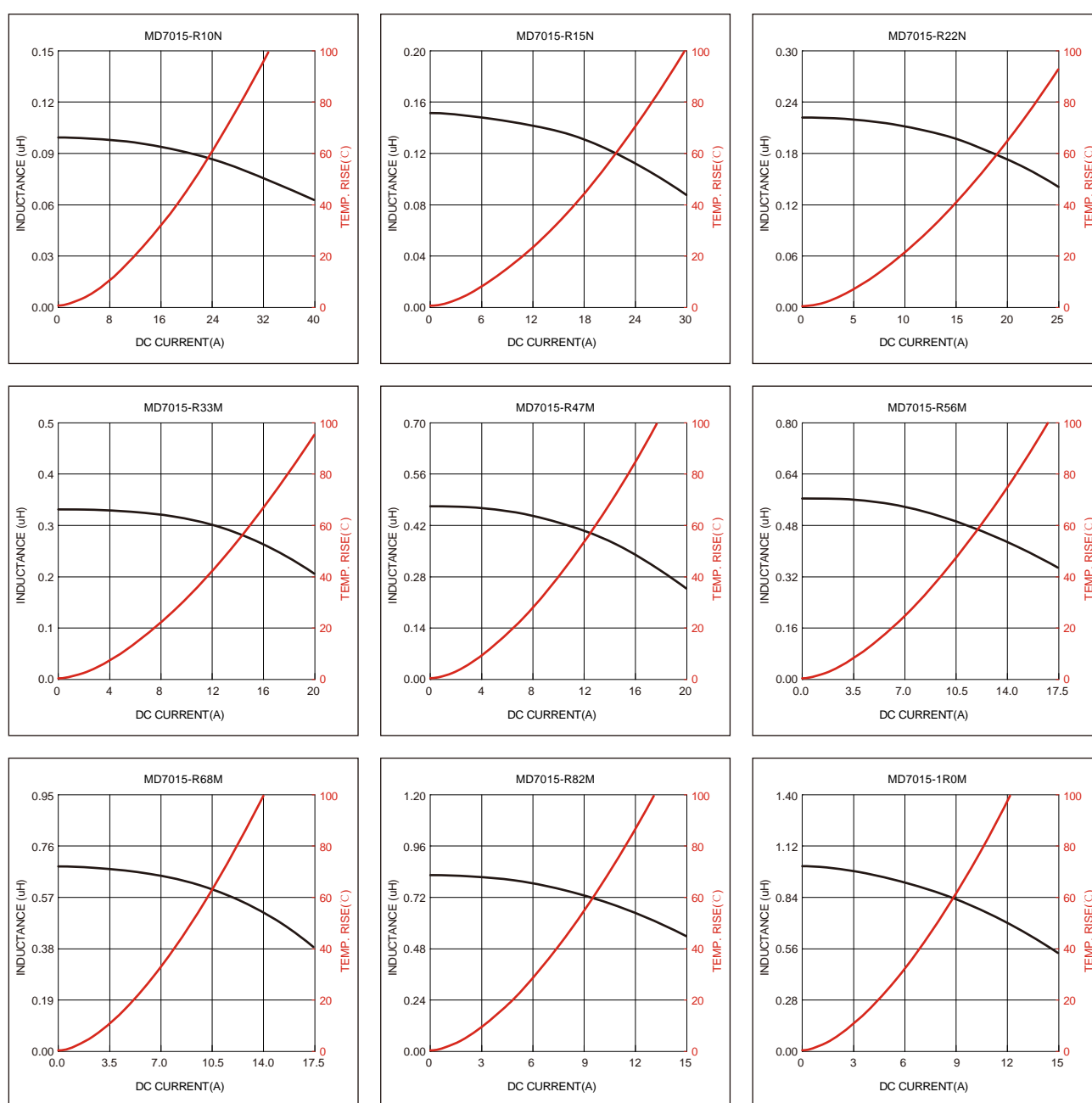



# Typical Electrical Characteristics:

